

**CURVE DATA**

TO	ANGLE	DELTA	ARC	CHORD	CHD/BRO	TANG
RA	86.00	74.19	36.11	103.30	50.21	48.66
AB	44.00	23.10	42.17	17.80	17.80	51.33
AC	25.00	82.30	18.38	38.00	32.37	45.13
AD	44.00	43.39	14.35	33.52	32.72	54.88
AE	44.00	43.39	14.35	33.52	32.72	59.27
AF	44.00	43.39	14.35	33.52	32.72	63.66
AG	44.00	43.39	14.35	33.52	32.72	68.05
AH	44.00	43.39	14.35	33.52	32.72	72.44
AI	44.00	21.32	28.16	16.17	16.08	81.88
AJ	114.00	10.31	41.25	24.35	48.72	46.14
AK	114.00	24.37	38.49	48.92	85.19	7.79
AL	114.00	12.33	54.25	24.35	48.72	24.88
AM	114.00	21.28	33.42	42.75	42.48	23.30
AN	114.00	11.24	11.13	11.13	11.55	12.55
AO	180.00	4.42	23.14	14.79	89.52	4.73
AP	114.00	21.16	16.44	42.22	42.22	13.67
AQ	44.00	11.31	58.88	8.84	72.48	49.49
AR	120.00	13.32	36.48	48.36	48.36	34.44
AS	44.00	282.30	19.20	59.16	38.46	46.46
AT	114.00	74.19	36.11	147.89	137.73	50.21
						48.66

**LINE DATA**

ID	BEARING	DIST
1	S13.12.00 E	24.13
2	S49.17.57 W	6.31
3	S82.59.00 W	30.00
4	S82.59.00 W	48.07
5	S82.59.00 W	33.08
6	N87.31.36 W	42.63
7	S49.43.36 W	41.22
8	N87.31.36 W	42.63
9	S52.42.59 W	31.82
10	S 2.28.24 W	45.00
11	S47.28.24 W	35.36
12	S 2.28.24 W	45.00
13	S26.18.59 W	16.58
14	N87.31.36 W	42.63
15	N87.31.36 W	19.80
16	N87.31.36 W	19.80
17	N82.18.55 E	31.82
18	S82.59.00 W	24.39

**SURVEYOR'S CERTIFICATE**  
 I hereby certify that the plan shown hereon is correct, that it is a subdivision of part of the land described in a conveyance from Maurice A. Berk, Trustee, of the Milestone-Berk Trust for Debra Faye Berk and Anton J. Berk to Wexford Development Corporation, a Maryland Corporation by deed dated Dec. 4, 1982 and recorded among the Land Records of Montgomery County, MD, in Liber 5980 at Folio 810. Iron pipes marked thus and monuments marked thus will be set where indicated.

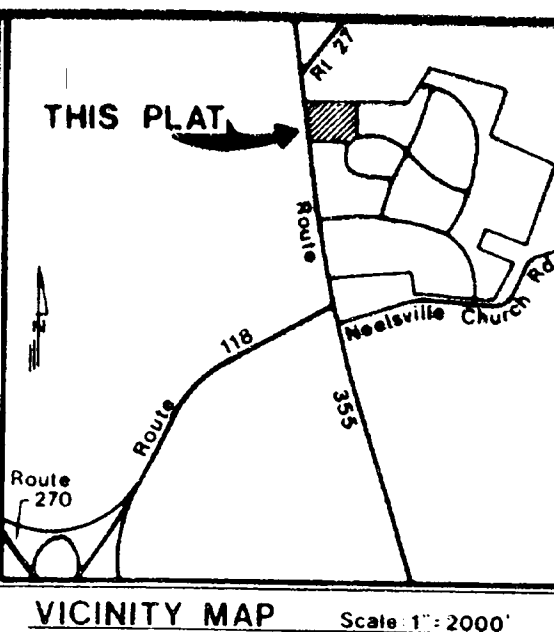

We, the undersigned, owners of the property described hereon, hereby adopt this plan of subdivision, dedicate the streets to public use, establish the minimum building restriction lines and grant to Montgomery County, MD, slope easements 25 feet wide across all lots adjacent, contiguous and parallel to all street right-of-way lines as required by Montgomery County Ordinance #4-115. Said slope easements shall be extinguished at such time as the public improvements on the abutting rights-of-way have been completed and accepted for maintenance by Montgomery County, MD.

Further, we grant to the Washington Suburban Sanitary Commission, their successors, agents and assigns, easements, designated hereon as "WSSC Esm't", for the construction, reconstruction, maintenance and operation of water mains, sanitary sewers and/or appurtenances.

Further, we grant to Montgomery County, MD, easements, designated hereon as "SD Esm't", for the construction, reconstruction, maintenance and operation of storm drains and/or appurtenances.

Further, we grant to Potomac Edison Company and to Chesapeake and Potomac Telephone Co. of MD and to their respective successors and assigns, an easement in, on and over the land hereon described as "Ten Foot Wide Public Utility Easement, designated hereon as "P.U.E." with the terms and provisions of such a grant being those set forth in a certain document entitled "Declaration of Terms and Provisions for Public Utility Easements" and recorded among the Land Records of Montgomery County, MD in Liber 3834 at Folio 457, said terms and provisions being incorporated herein by this reference.

Further, we grant to Montgomery County, MD, a ten foot wide "Public Improvement Easement" designated hereon as "P.I.E.". Said easement being granted with the terms and provisions set forth in a certain document entitled "Declaration of Easement" recorded among the Land Records of Montgomery County, MD in Liber 5882 at Folio 808. Said terms being incorporated herein by this reference.

There are no recorded suits, actions of law, liens, leases, mortgages or trusts affecting the property included in this plan of subdivision, except certain deeds of trusts, and all parties in interest thereto have below indicated their assent.

We hereby assent to this plan: Date 9/1/82

WEXFORD DEVELOPMENT CORPORATION  
 by *Maurice A. Berk* (Seal)  
 Maurice A. Berk, Trustee  
*Anton J. Berk* (Seal)  
 Anton J. Berk, Trustee  
*David Brooks*  
 David Brooks, Trustee  
*Jerome Lewis*  
 Jerome Lewis, Trustee  
*Howard G. Dwyer*  
 Howard G. Dwyer, Trustee  
*Constance Britt*  
 Constance Britt, Trustee

**AREA TABULATION**

Lots (20)	3.37883 ac.
Parcel "C"	0.29848 ac.*
Street Dedication	0.75407 ac.
TOTAL	4.43138 ac.

(\* Private Open Space)

**LOTS 45-64, PARCEL C, BLOCK F**  
**WEXFORD**  
 Ninth Election District  
 Montgomery County, Maryland  
 SCALE: 1"=50'  
 DECEMBER, 1982

FOR PUBLIC SEWER AND WATER SYSTEMS ONLY

MARYLAND NATIONAL CAPITAL PARK AND PLANNING COMMISSION  
 MONTGOMERY COUNTY PLANNING BOARD

APPROVED: *Thomas P. Cristelli* (Seal)  
 Thomas P. Cristelli, Chairman  
 APPROVED: *John A. ...*  
 Secretary/Treasurer

M.N.C.P. & P.C. RECORD FILE NO. **647.03**

2-2222117833028012800 R.M.H.  
 MONTGOMERY COUNTY, MARYLAND  
 DEPARTMENT OF TRANSPORTATION

APPROVED: *Donald R. Cihy* (Seal)  
 Donald R. Cihy, Director

RECORDED: \_\_\_\_\_  
 PLAT BOOK: \_\_\_\_\_  
 PLAT NO.: \_\_\_\_\_

**LOIEDERMAN ASSOCIATES, Inc.**  
 CIVIL ENGINEERS - LAND SURVEYORS  
 200-A Monroe Street  
 Rockville, Maryland  
 (301) 762-0882 36-80-04

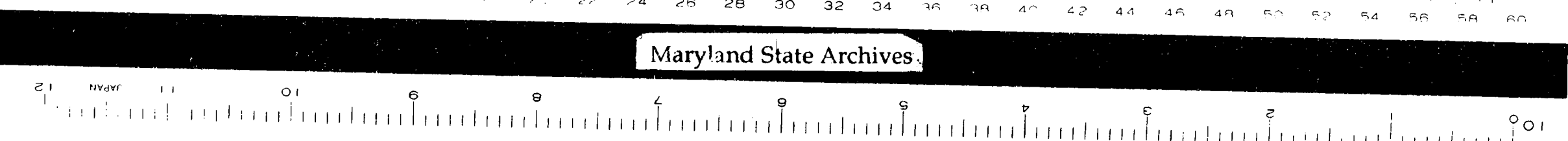

MONTGOMERY COUNTY CIRCUIT COURT (Subdivision Plats, MO) Plat 14116, MSA\_51249\_20321, Date available 1982/12/30, Printed 04/09/2021.